

FEEDER

SINGLE SHAFT GRIZZLY FEEDER

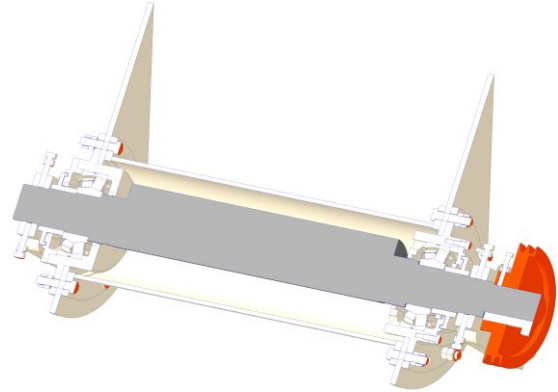

DOUBLE SHAFT GRIZZLY FEEDER

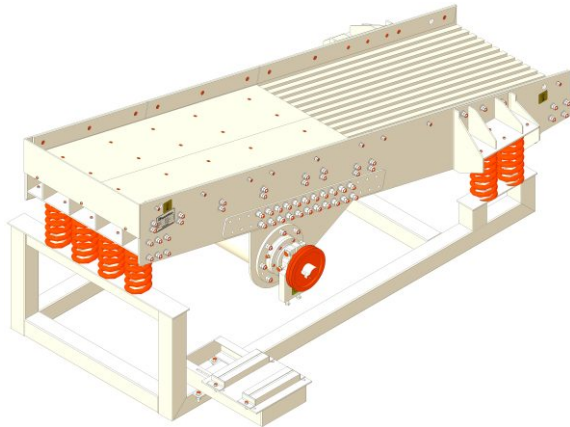
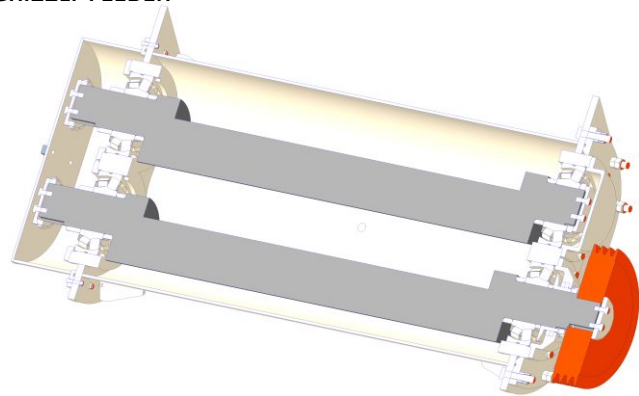
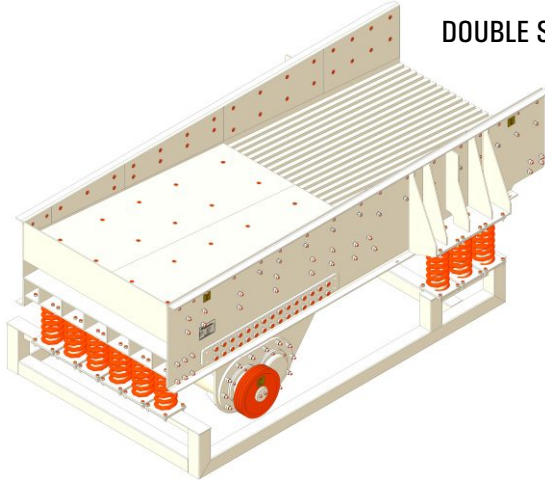

VIBRATORY GRIZZLY FEEDER

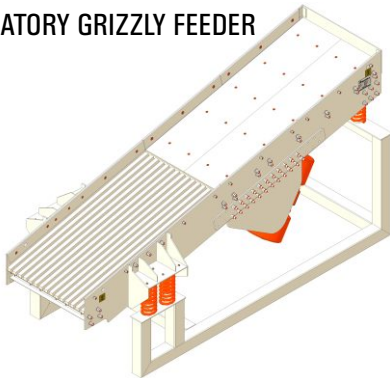

VIBRATORY PAN FEEDER

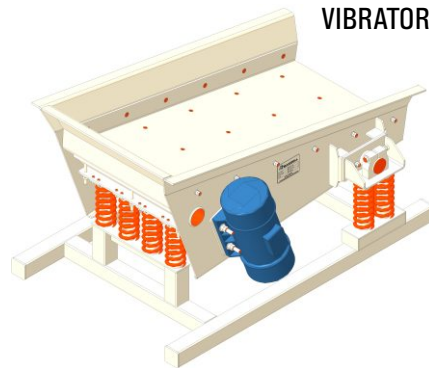

SALIENT FEATURES

- RIGID CONSTRUCTION
- EXPOSED AREAS ARE COVERED WITH REPLACEABLE WEAR LINERS
- EASY ADJUSTMENT OF VIBRATION AMPLITUDE
- HIGH ADAPTABILITY DUE TO WIDE VARIETY

UNIT - 1



UNIT - 2



WEB



TECHNICAL DATA - SINGLE SHAFT GRIZZLY FEEDER

Model Name	Feeder Size (Width mm x Length mm)	Maximum Feed Size (mm)	Throughput Capacity (TPH)	Required Power (KW / HP)	Type Of Vibrator
MGFSS 1036	1000 x 3600	500	150	15 / 20	Circular Mechanical
MGFSS 1040	1000 x 4000	500	150	15 / 20	Circular Mechanical
MGFSS 1240	1200 x 4000	600	200	18.5 / 25	Circular Mechanical

TECHNICAL DATA - DOUBLE SHAFT GRIZZLY FEEDER

Model Name	Feeder Size (Width mm x Length mm)	Maximum Feed Size (mm)	Throughput Capacity (TPH)	Required Power (KW / HP)	Type Of Vibrator
MGFDS 1240	1200 x 4000	600	200	22 / 30	Linear Mechanical
MGFDS 1540	1500 x 4000	750	300	30 / 40	Linear Mechanical

TECHNICAL DATA - VIBRATORY GRIZZLY FEEDER

Model Name	Feeder Size (Width mm x Length mm)	Maximum Feed Size (mm)	Throughput Capacity (TPH)	Required Power (KW / HP)	Type Of Vibrator
VFG 1036	1000 x 3600	500	150	7.4 (3.7 x 2) / 10 (5 x 2)	Linear Electrical
VFG 1040	1000 x 4000	500	150	7.4 (3.7 x 2) / 10 (5 x 2)	Linear Electrical
VFG 1240	1200 x 4000	600	200	7.4 (3.7 x 2) / 10 (5 x 2)	Linear Electrical
VFG 1540	1500 x 4000	750	300	11 (5.5 x 2) / 15 (7.5 x 2)	Linear Electrical

TECHNICAL DATA - PAN FEEDER

Model Name	Feeder Size (Width mm x Length mm)	Maximum Feed Size (mm)	Throughput Capacity (TPH)	Required Power (KW / HP)	Type Of Vibrator
VPF 0818	800 x 1800	200	200	3 (1.5 x 2) / 4 (2 x 2)	Linear Electrical
VPF 1220	1200 x 2000	250	250	4.4 (2.2 x 2) / 6 (3 x 2)	Linear Electrical
MPFSS 0818	800 x 1800	200	80	5.5 / 7.5	Circular Mechanical

Note :-

- Mentioned Sizes Are Standard Sizes, User Required Customized Size Can Be Made Based On Requirement.
- The Capacity Indicated Is Maximum Feeding Capacity Based On Continuous Regulated Fresh Feed Of Clean, Normal Hardness With A Bulk Density Of 1.6 Ton/M3. Capacities May Vary +/- 25% Depending Upon Type Of Material, Moisture Content, Plasticity, Gradation And General Flow-ability Of The Material. Capacities Reduced Considerably When Handling Coarse Or Sticky Material.
- Capacity Can Be Altered By Throw And / Or Speed.
- Vibratory Grizzly Feeder Are Equipped With Twin Vibratory Motor.
- The Detail Including Display, Construction, Technical Information, Etc. Are For Information Only And Subject To Change Without Prior Notice.
- Scope Of Supply May Differ From The Display Presented Here And It Is Fully As Per The Commercial Offer.

MAXWELL CRUSHTECH

📍 UNIT-1 : Block No. 188, Opp. Futura Engineering, Isand Road, At.: Chhatral, Tal.: Kalol, Dist.: Gandhinagar, Gujarat-382729, INDIA.

📍 UNIT-2 : 26, At.: Bibipura, Opp. Giriraj Petroleum, Tal.: Bayad, Dist.: Aravalli, Gujarat-383325, INDIA.

☎ : +91-99251 25175, +91-99252 45504

✉ : maxwelldapatel@gmail.com , dpatel@maxwellcrushtech.com